

The details shown on this drawing are confidential and the drawing is the exclusive property of Halliday Clark Limited. No use, copy or disclosure of the drawing may be made without our permission and it is to be returned to Halliday Clark Limited when required. Halliday Clark Limited take no responsibility for the use of this drawing for any purpose other than for that which it was intended. All dimensions are in millimeters unless stated otherwise. All dimensions should be verified on site prior to commencement of works. Do not scale from this drawing. All works must be in accordance with British Standards, EC Standards, Health & Safety at work act & all other relevant regulations & Bye Laws. Any discrepancies should be brought to the attention of Halliday Clark Limited.

Key

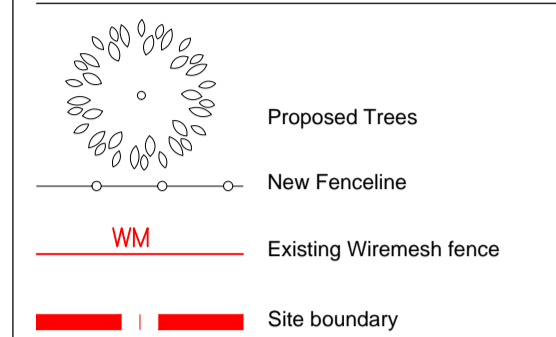

Schedule of Accommodation

2 no. 2B3P Apartment (Type 201)	62.5sqm (672sqft)
2 no. 2B3P Apartment (Type 202)	67.3sqm (724sqft)
1 no. 2B3P Apartment (Type 203)	62.5sqm (672sqft)
1 no. 2B3P Apartment (Type 204)	70.0sqm (753sqft)
2 no. 1B2P Apartment (Type 14)	52.5sqm (565sqft)
2 no. 1B2P Apartment (Type 15)	55.2sqm (594sqft)
Total	10 units

Site Area 1517m² / 0.15Ha / 0.37acre

H - 04.03.2019	JW
PLANNING ISSUE	
G - 08.06.2018	SJ
Revised apartment position, dotted line indicating old position. Existing vehicle access and drive indicated. Reversing dim added.	
F - 08.06.2018	GW
Topographical survey incorporated. Drawing revised to RIBA 3. Prepared for public consultation.	
E - 17.08.2017	SJ
Block moved over to retain hedge outside unit 9 & 10. Footpath and car parking altered as a result. Topographical survey introduced.	
D - 06.06.2017	SJ
Revised scheme in line with IS comments.	
C - 02.06.2017	SJ
Revised in line with Batch 3 review comments. Emergency vehicle denoted along with distance. Building mirrored and entry footpath moved as a result. Car parking area modified to allow more aspect distance for plots 1-6, distances denoted on drawing for clarity. Bedroom window moved due to overlooking aspect distance at units 8-10.	
B - 17.05.2017	SJ
revised following meeting with planners.	
A - 14.05.2017	SAE
Revised in line with FCC comments	
- 21.02.2017	MJS
INITIAL ISSUE	
REVISION - DATE	DRWN / CHKD

FOR APPROVAL

Fford Hiraethog
Maes Pennant
Mostyn
CH8 9PE

FOR
Wates Residential

Proposed Site Layout

Scale 1:200 @ A1

HALLIDAY CLARK
ARCHITECTS

Halliday Clark Limited T 01943 604 123
21 The Grove E info@hallidayclark.co.uk
Ilkley LS29 9LW W hallidayclark.co.uk

Dwg. No. 671.15 (-) 001

Rev. H

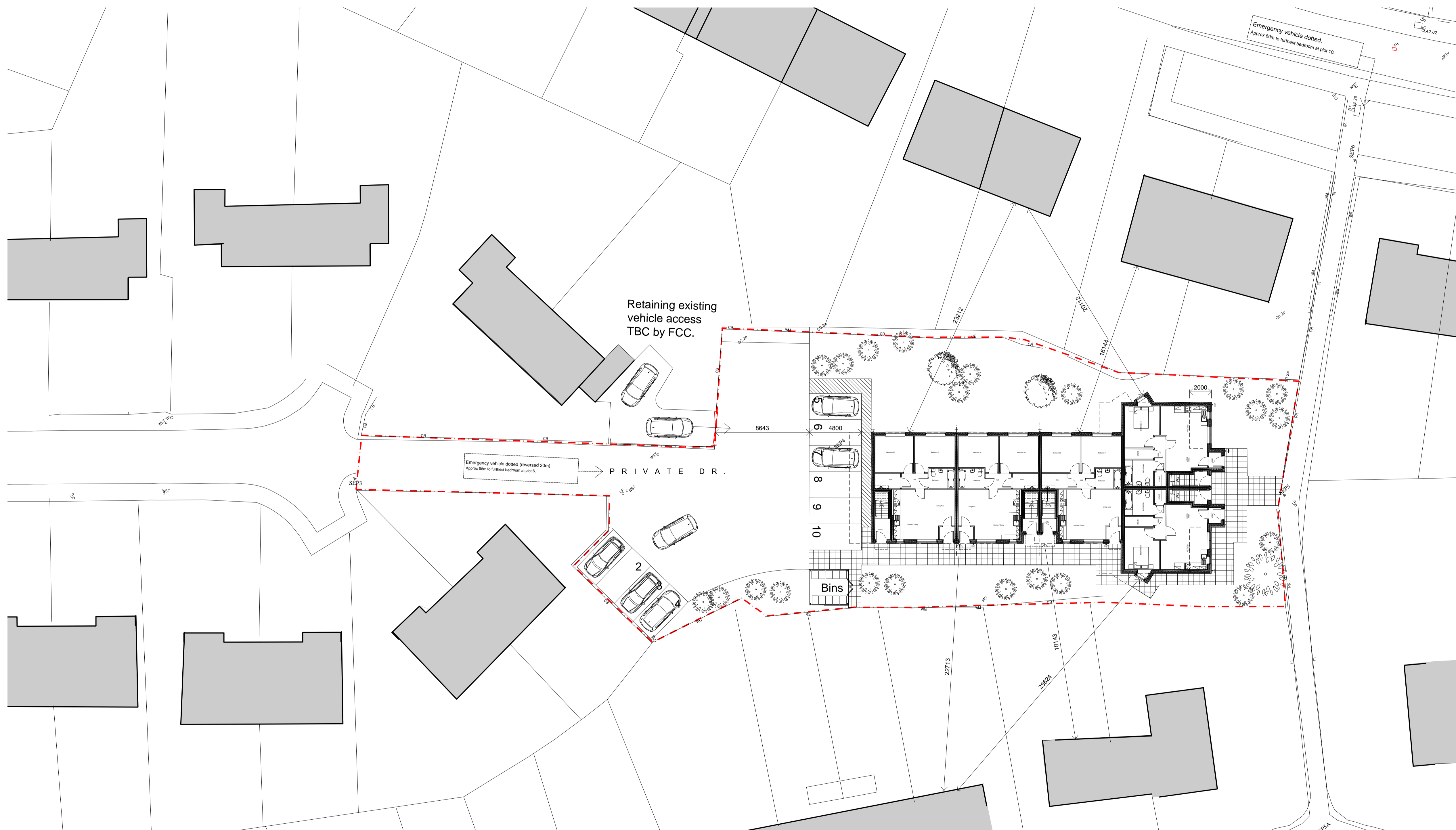

Proposed Site Layout
Scale 1:200
0 2000 5000 10000 15000mm